

## CARATTERISTICHE TECNICHE

Tipo	Modello	Potenza kW		Alimentazione elettrica	Motore ventilatore kW	Motore pompa kW	Attacchi gas
		min.	max.				
<b>HS5</b>	MG.TN.x.IT.A.0.15	35	70	230 V 1N ac	0,10	0,1	1/2"
<b>HS10</b>	MG.TN.x.IT.A.0.20	65	140	230 V 1N ac	0,15	0,1	3/4"
<b>HS18</b>	MG.TN.x.IT.A.0.25	80	200	230 V 1N ac	0,15	0,1	1"

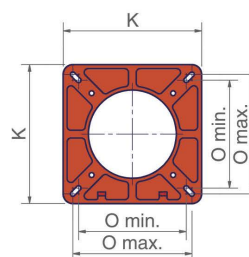

Flangia bruciatore

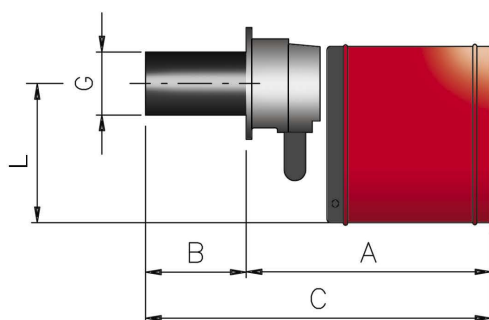
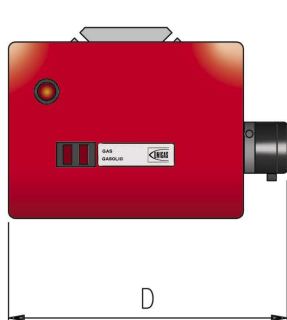
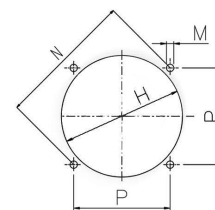

Foratura caldaia consigliata

Tipo	Dimensioni imballo (mm)			
	l	p	h	kg
<b>HS5</b>	580	580	360	23
<b>HS10</b>	510	350	730	30
<b>HS15</b>	510	350	730	31

Valori indicativi

Tipo	Modello	Dimensioni di ingombro (mm)								Foratura caldaia (mm)				Flangia bruciatore (mm)			
		A	B	BL	C	CL	D	G	L	H	M	N	P		K	O	
													min.	max.		min.	max.
<b>HS5</b>	MG.TN.x.IT.A.0.15	320	0÷61	0÷160	380	480	400	80	190	90	M8	130÷189	92	134	162	86	138
<b>HS10</b>	MG.TN.x.IT.A.0.20	351	159	254	510	605	430	108	210	115	M8	148÷189	105	134	162	103	103
<b>HS18</b>	MG.TN.x.IT.A.0.25	348	177	267	525	615	430	126	210	135	M8	148÷189	105	134	162	103	103

Valori indicativi