

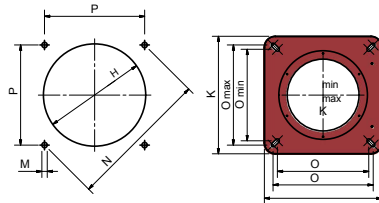

TECHNICAL DETAILS

Type	Model	Power kW		Auxiliary electrical power supply	Motor electrical power supply	Fan motor kW	Pump motor kW	Gas connections	Noise level dBA
		min.	max.						
K590X	MG.xx.xR.xx.A.1.xxx	670	5.900	230 V 1N AC 50 Hz	400 V 3 AC 50 Hz	15,0	1,5	DN65 - DN80 - DN100 - DN125	< 85
K750X	MG.xx.xR.xx.A.1.xxx	860	7.500	230 V 1N AC 50 Hz	400 V 3 AC 50 Hz	15,0	2,2	DN65 - DN80 - DN100 - DN125	< 85

For the configuration of the gas train, see pages 116-117.

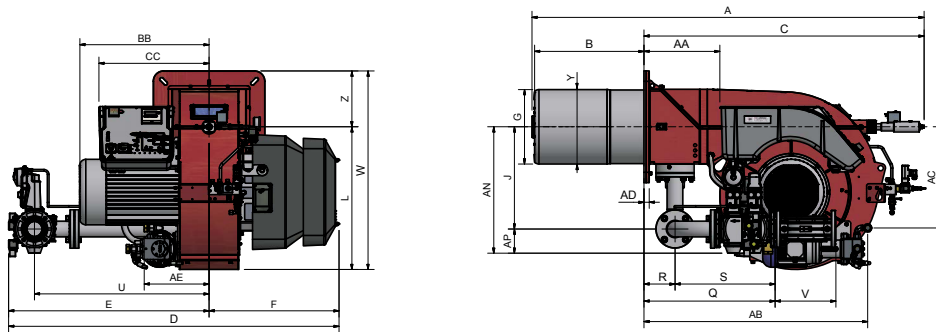

Suggested boiler drilling

Burner flange

Type	Packaging dimensions (mm)			
	l	p	h	kg
K590X	2180	1450	1220	495
K750X	2180	1450	1220	530

Approximate values

Type	Model	Overall dimensions (mm)																																		
		AS	AL	AA	AB	AC	AD	AE	AN	AP	BS	BL	BB	C	CC	D	E	F	G	H	J	K	L	M	N	O	P	Q	R	S	U	V	W	Y	Z	
K590X	MG.xx.xR.xx.A.1.65	1785	1885	366	1082	670	25	314	611	117	430	530	626	1355	524	1595	969	626	360	400	494	540	690	M16	651	460	460	460	636	150	487	845	292	960	356	270
K590X	MG.xx.xR.xx.A.1.80	1785	1885	366	1082	670	25	314	626	132	430	530	626	1355	524	1628	1002	626	360	400	494	540	690	M16	651	460	460	460	687	150	538	875	313	960	356	270
K590X	MG.xx.xR.xx.A.1.100	1785	1885	366	1082	670	25	314	639	145	430	530	626	1355	524	1708	1082	626	360	400	494	540	690	M16	651	460	460	460	791	150	642	942	353	960	356	270
K590X	MG.xx.xR.xx.A.1.125	1785	1885	366	1082	670	25	314	738	175	430	530	626	1355	524	1973	1347	626	360	400	562	540	690	M16	651	460	460	904	150	754	1192	479	960	356	270	
K750X	MG.xx.xR.xx.A.1.65	1785	1885	366	1073	670	25	300	611	117	430	530	626	1355	524	1595	969	626	419	470	494	540	690	M16	651	460	460	636	150	487	845	292	960	336	270	
K750X	MG.xx.xR.xx.A.1.80	1785	1885	366	1073	670	25	300	626	132	430	530	626	1355	524	1628	1002	626	419	470	494	540	690	M16	651	460	460	687	150	538	875	313	960	336	270	
K750X	MG.xx.xR.xx.A.1.100	1785	1885	366	1073	670	25	300	639	145	430	530	626	1355	524	1708	1082	626	419	470	494	540	690	M16	651	460	460	791	150	642	942	353	960	336	270	
K750X	MG.xx.xR.xx.A.1.125	1785	1885	366	1073	670	25	300	738	175	430	530	626	1355	524	1973	1347	626	419	470	562	540	690	M16	651	460	460	904	150	754	1192	479	960	336	270	

Approximate values